

# ALMA SOUNDER

SURVEY VESSEL - 375 HP

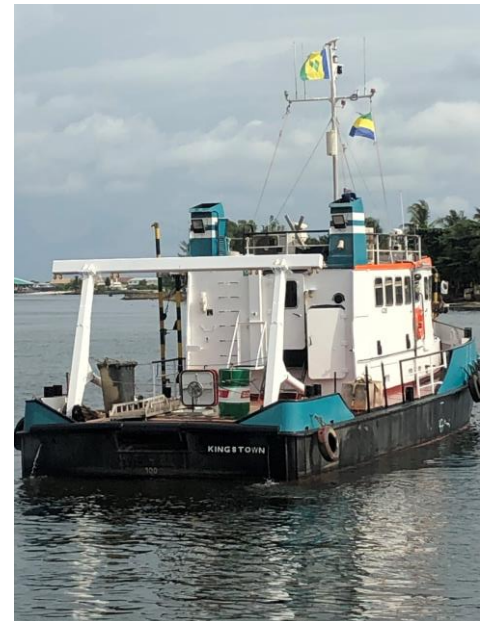

## CLASSIFICATION / FLAG

Built	1982
Rebuilt	2017
Flag	Togo
Trading Area	Coastal Waters
Call sign	5VAR2
IMO	8433899
Classification Society	NA
Class Ship	NA

## PRINCIPAL DIMENSIONS

Length o.a	20.08m
Breadth o.a	5.8m
Draft	0.8m
GRT	53
NRT	15

## MISCELLANEOUS

Hydraulic A-Frame	1.5 MT
Moonpool	700 mm hull integrated
Push Fender	

## MACHINERY / PROPULSION

Maximum speed	6 knots
Economic speed	4 knots
Main engines	2 x Sizu 620 DSM
Propulsion	Propellers : 2 x 4blades & bow thruster hydraulic drive
Auxiliary engines	16-50 Kva

## TANK / STORAGE CAPACITIES

Fuel	6.9 m <sup>3</sup>
Fresh Water	2.1 m <sup>3</sup>

## NAVIGATION & COMMUNICATION SYSTEMS

Fully equipped / GMDSS VHF

## ACCOMMODATION

Berths	8
	<i>incl. double cabins</i> 4
Spacious survey room / Fully airconditioned	
Mess-Dayroom / Galley / Sanitary facilities	

**ALMA SHIPPING**

Head office: 26 avenue de Saint Cloud 78000 Versailles

[www.almashipping.com](http://www.almashipping.com) / [chartering@almashipping.com](mailto:chartering@almashipping.com)

*Details are believed to be correct but cannot be guaranteed and are subject to change*

# ALMA SOUNDER

SURVEY VESSEL - 375 HP

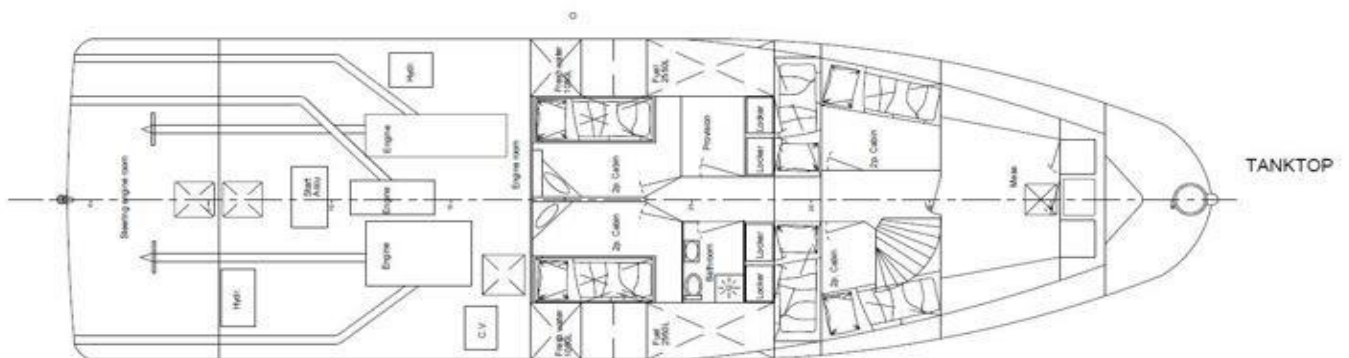
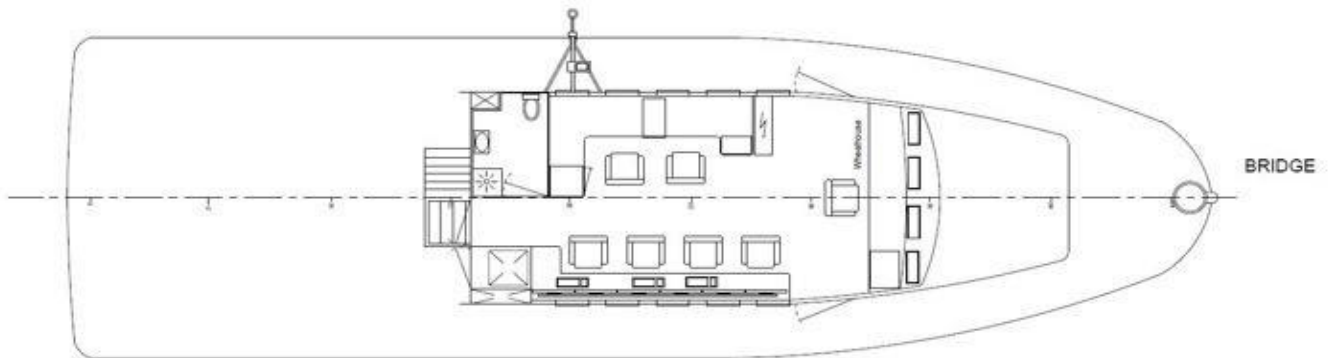
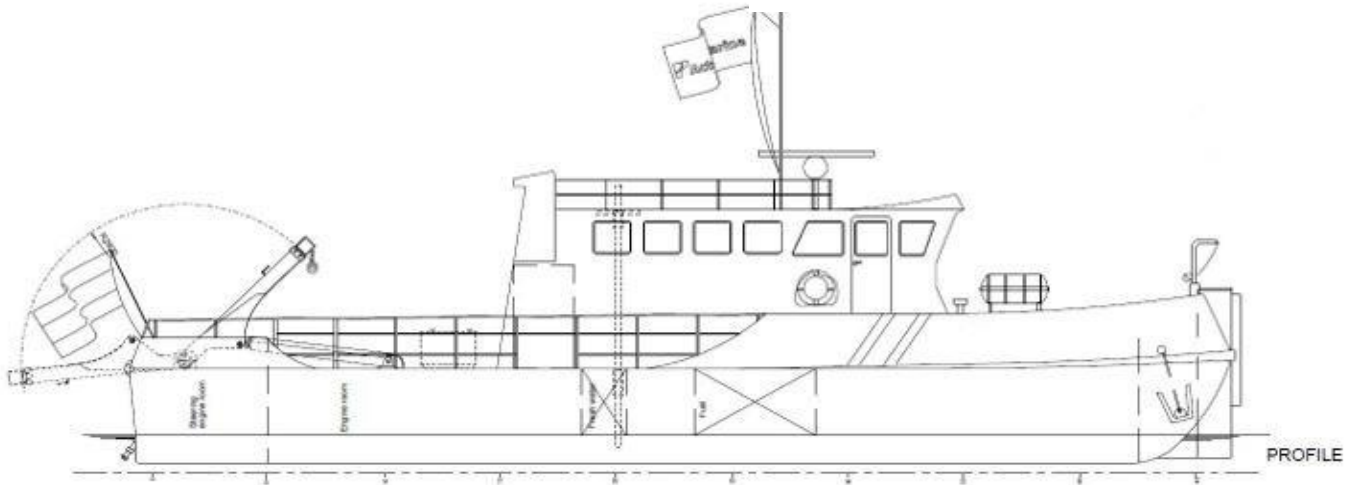

**ALMA SHIPPING**

Head office: 26 avenue de Saint Cloud 78000 Versailles

[www.almashipping.com](http://www.almashipping.com) / [chartering@almashipping.com](mailto:chartering@almashipping.com)

*Details are believed to be correct but cannot be guaranteed and are subject to change*

# ALMA SOUNDER

SURVEY VESSEL - 375 HP

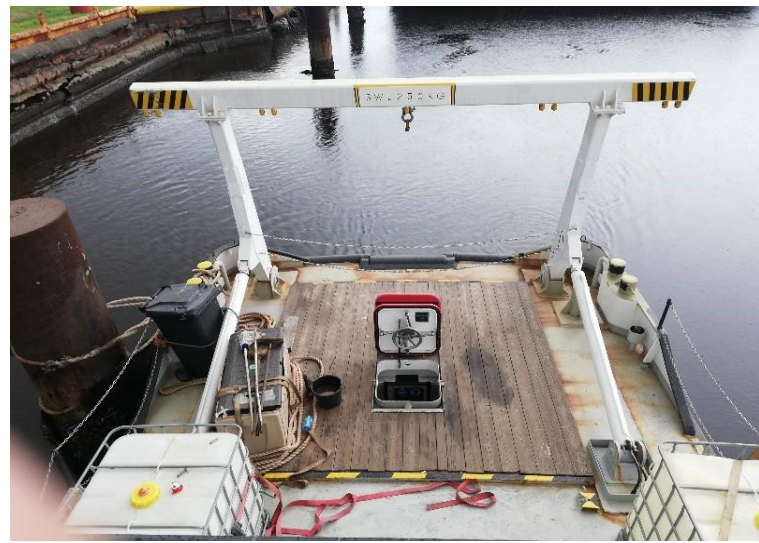

**ALMA SHIPPING**

Head office: 26 avenue de Saint Cloud 78000 Versailles

[www.almashipping.com](http://www.almashipping.com) / [chartering@almashipping.com](mailto:chartering@almashipping.com)

*Details are believed to be correct but cannot be guaranteed and are subject to change*